

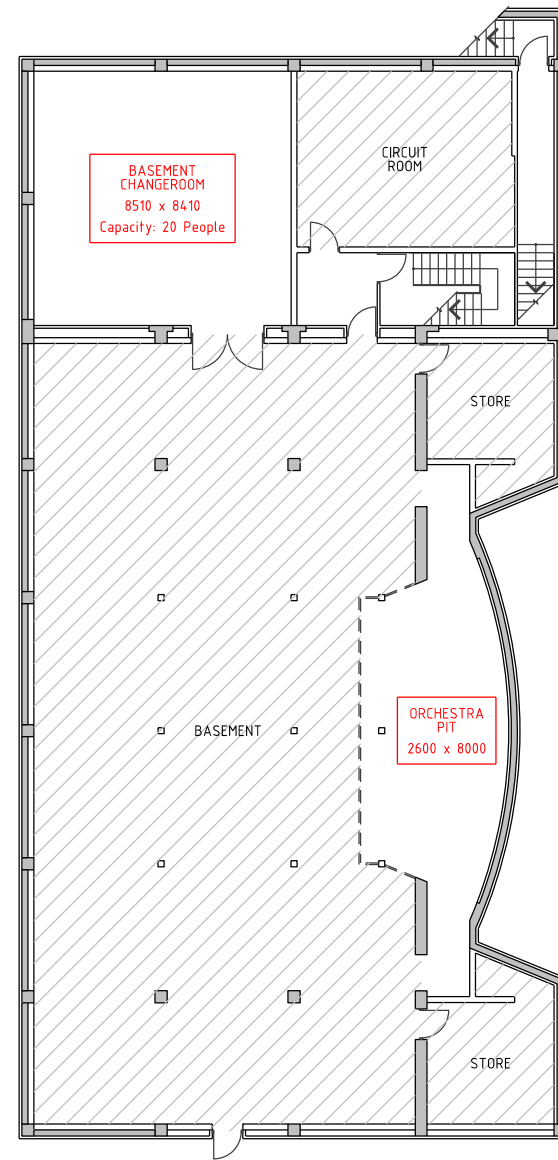

AREAS NOT FOR HIRE



BASEMENT LEVEL



PO Box 101 Geraldton WA 6531
 Geraldton Civic Centre T 08 9956 6600 F 08 9956 6674
 Mullewa District Office T 08 9956 6643 F 08 9961 1206
 E council@cgg.wa.gov.au W www.cgg.wa.gov.au

DESIGNED:	RJ THORP	DATE:	MAY 2016
DRAWN:	RJ THORP	DATE:	MAY 2016
CHECKED:		DATE:	
APPROVED BY:		DATE:	

DEPARTMENT
INFRASTRUCTURE SERVICES

PROJECT TITLE:	CGG BUILDINGS	
	Equipment and Facilities	
DRAWING TITLE:	QUEENS PARK THEATRE, Cathedral Avenue	
	FILE LOC:	D-16-33294 [TRIM Reference]
DRAWING NUMBER:	MISC195-1	REVISION NUMBER:

PAPER SIZE:	A3
SURVEYED BY:	NA
DATE SURVEYED:	NA
DATUM:	H NA V NA
SCALE:	1:250
REVISION NUMBER:	2

AMENDMENTS	2.	APR-20	ROOMS FOR HIRE DETAILS AND SHADING	RJT	JP
	1.	MAY-16	ISSUED FOR COMMENT	RJT	-
	NO.	DATE	DESCRIPTION	BY	APPR.



AREAS NOT FOR HIRE

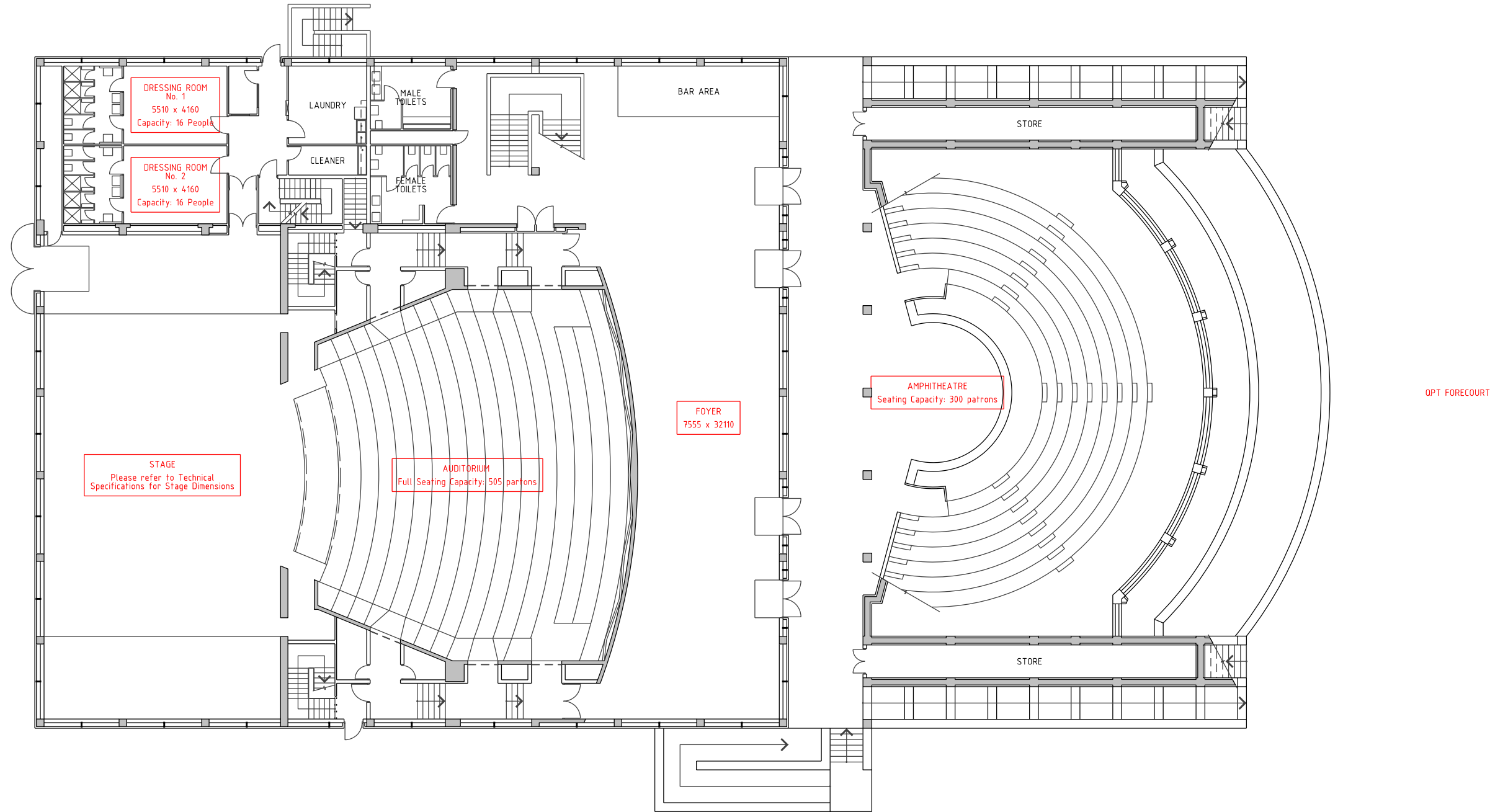

Queens Park Gardens

AUDITORIUM LEVEL (Ground Floor)



PO Box 101 Geraldton WA 6531
 Geraldton Civic Centre T 08 9956 6600 F 08 9956 6674
 Mullewa District Office T 08 9956 6643 F 08 9961 1206
 E council@cgg.wa.gov.au W www.cgg.wa.gov.au

DESIGNED: RJ THORP DATE: MAY 2016
 DRAWN: RJ THORP DATE: MAY 2016
 CHECKED: DATE:
 APPROVED BY: DATE:

DEPARTMENT
INFRASTRUCTURE SERVICES

PROJECT TITLE:
**CGG BUILDINGS
 Equipment and Facilities**

DRAWING TITLE:
QUEENS PARK THEATRE, Cathedral Avenue

FILE LOC: D-16-33294 [TRIM Reference]

DRAWING NUMBER: **MISC195-2**

PAPER SIZE: A3
 SURVEYED BY: NA
 DATE SURVEYED: NA
 DATUM: H NA
 V NA
 SCALE: 1:250
 REVISION NUMBER: **2**

AMENDMENTS	NO.	DATE	DESCRIPTION	BY	APPR.
	2.	APR-20	ROOMS FOR HIRE DETAILS AND SHADING	RJT	JP
	1.	MAY-16	ISSUED FOR COMMENT	RJT	-



AREAS NOT FOR HIRE

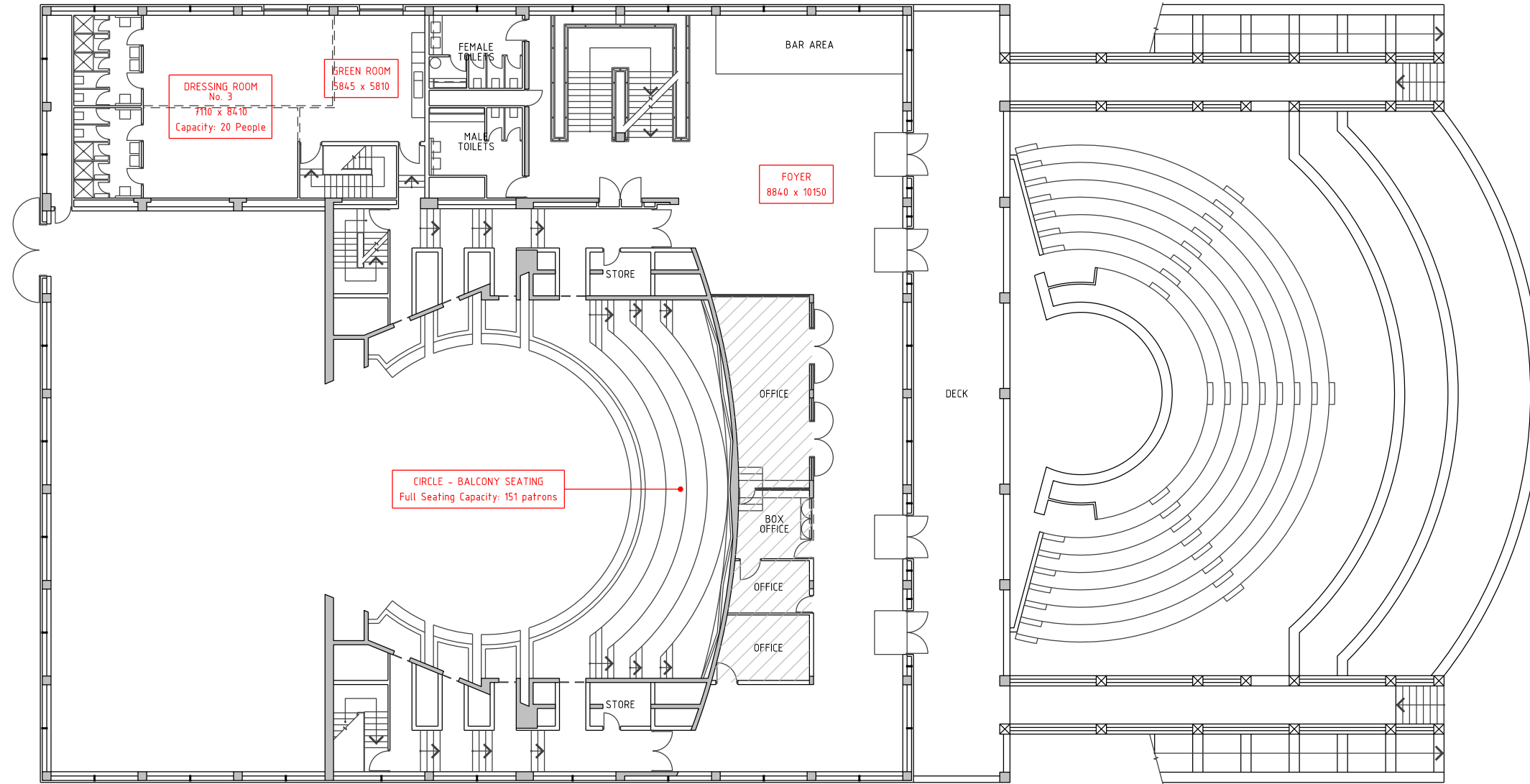

CIRCLE LEVEL (2nd Floor)



PO Box 101 Geraldton WA 6531
 Geraldton Civic Centre T 08 9956 6600 F 08 9956 6674
 Mullewa District Office T 08 9956 6643 F 08 9961 1206
 E council@cgg.wa.gov.au W www.cgg.wa.gov.au

DESIGNED: RJ THORP DATE: MAY 2016
 DRAWN: RJ THORP DATE: MAY 2016
 CHECKED: DATE:
 APPROVED BY: DATE:

DEPARTMENT
**INFRASTRUCTURE
 SERVICES**

PROJECT TITLE:
**CGG BUILDINGS
 Equipment and Facilities**

DRAWING TITLE:
QUEENS PARK THEATRE, Cathedral Avenue

FILE LOC: D-16-33294 [TRIM Reference]

DRAWING NUMBER: **MISC195-3**

PAPER SIZE: A3
 SURVEYED BY: NA
 DATE SURVEYED: NA
 DATUM: H NA
 V NA
 SCALE: 1:250
 REVISION NUMBER: **2**

AMENDMENTS	NO.	DATE	DESCRIPTION	BY	APPR.
	2.	APR-20	ROOMS FOR HIRE DETAILS AND SHADING	RJT	JP
	1.	MAY-16	ISSUED FOR COMMENT	RJT	-



AREAS NOT FOR HIRE

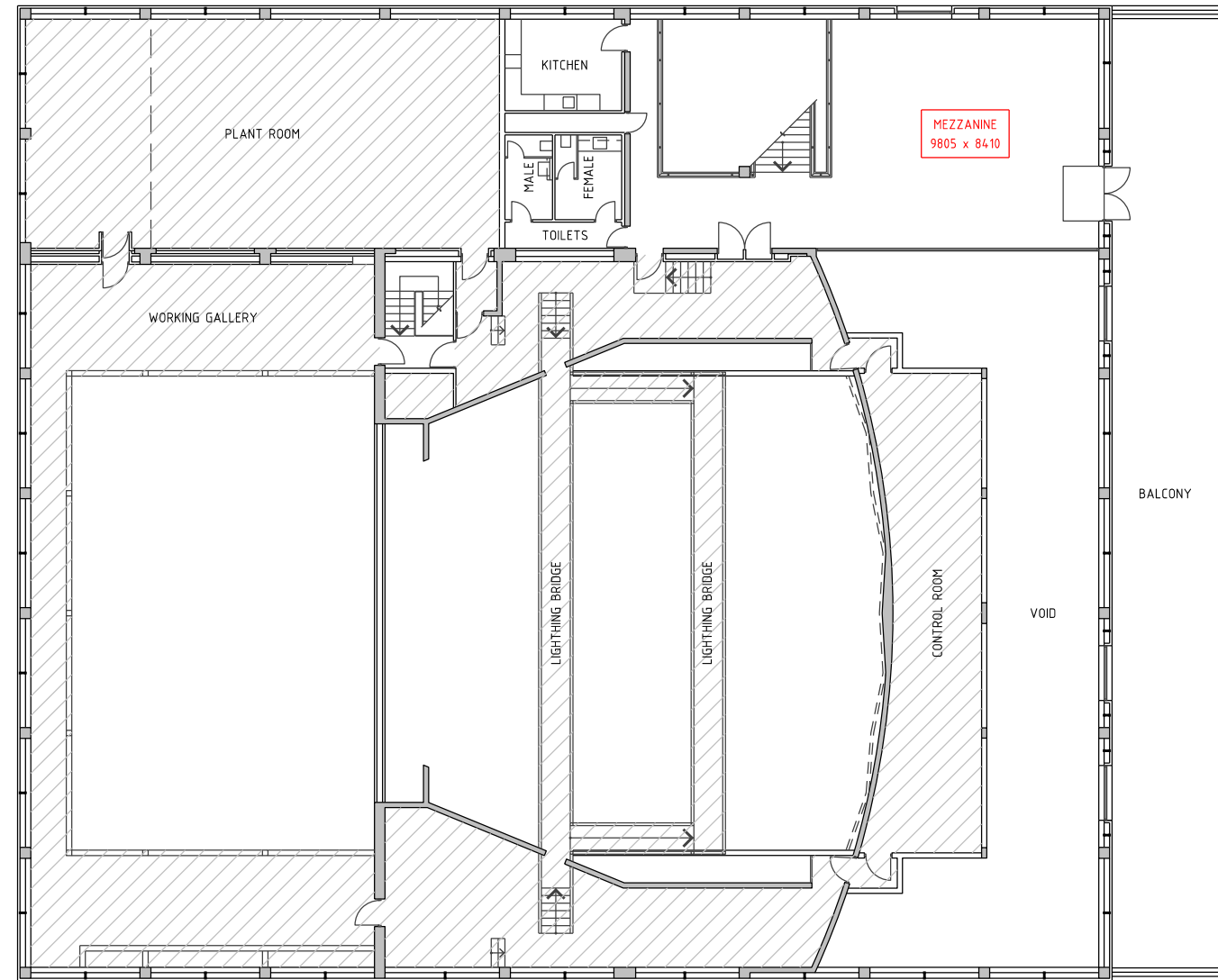

CONTROL LEVEL (3rd Floor)



PO Box 101 Geraldton WA 6531
 Geraldton Civic Centre T 08 9956 6600 F 08 9956 6674
 Mullewa District Office T 08 9956 6643 F 08 9961 1206
 E council@cgg.wa.gov.au W www.cgg.wa.gov.au

DESIGNED: RJ THORP DATE: MAY 2016
 DRAWN: RJ THORP DATE: MAY 2016
 CHECKED: DATE:
 APPROVED BY: DATE:

DEPARTMENT
**INFRASTRUCTURE
 SERVICES**

PROJECT TITLE:

CGG BUILDINGS
Equipment and Facilities

DRAWING TITLE:

QUEENS PARK THEATRE, Cathedral Avenue

FILE LOC:

D-16-33294 [TRIM Reference]

DRAWING NUMBER:

MISC195-4

PAPER SIZE: A3

SURVEYED BY: NA

DATE SURVEYED: NA

DATUM: H NA
 V NA

SCALE: 1:250

REVISION NUMBER: 2

AMENDMENTS	NO.	DATE	DESCRIPTION	BY	APPR.
	2.	APR-20	ROOMS FOR HIRE DETAILS AND SHADING	RJT	JP
	1.	MAY-16	ISSUED FOR COMMENT	RJT	-